

Wyoming Certified Land Corner Recordation Certificate

This form is to be completed in accordance with W.S. 36-11-101, printed in black ink or typed, and shall be for one individual corner.

Describe below, or show in sketch attached to this form, the corner evidence found. Include condition and type of monument, accessories and ties. Describe any maintenance or rehabilitation performed. In the circle to the right, show monument inscription. If monument is determined lost or obliterated, restate the GLO or BLM original field note record; describe or show the procedure used to reestablish the corner and all data as above for a found monument.

Field Date 4-11-90 Office Reference _____

After extensive field search, it was determined the best evidence for the re-establishment of the corner was the straight-line proportion between the two found section corners on the westerly line of Section 26.

GLO notes attached.

Monument set: #5 rebar with 2" aluminum cap stamped as shown; 6" below gravel road.

References: P-K nails with 1-1/2" galvanized washers stamped "5014".

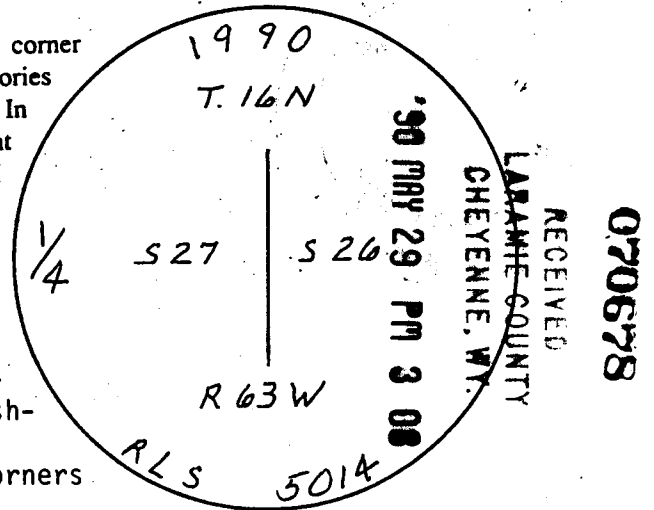

Monument Inscription

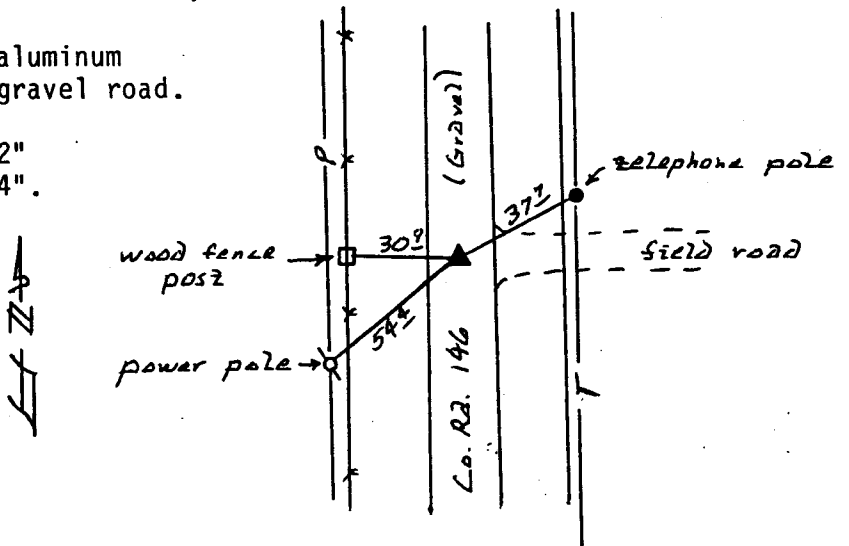

State of Wyoming
Office of County Clerk
County of Laramie

This Certified Land Corner Recordation Certificate was filed for record on the _____ day of _____, 19 ____, in Book No. T _____, R _____, on Alpha-Numeric coordinates T 17 and was noted on the Cross Index Plat.

County Clerk

Corner Type:
 Aliquot Corner Other

Section(s) 26 Meridian 6th

Corner Name Quarter Township 16N Range 63W Page _____

Sheet 1 of 3

**Directions for using the
Cross Index Plat**

Section, quarter and sixteenth corners will be marked with a dot at the corner location. The alpha-numeric coordinate number is then determined for the intersection of the two lines. A corner that applies to two or more townships shall be filed under all that apply by the use of photo copies.

Closing corners will be indexed under the township in which they control ownership. For 1/64, 1/256, 1/1024 and non-aliquot corners lying between grid designations, mark the appropriate grid area with a dot and use the index code to the north and west (local systems may be used if the method is approved by the County Surveyor or Clerk and a written description of its use is filed in the front of each book of certificates).

Cross Index Plat

	1	2	3	4	5	6	7	8	9	10	11	12	13	14	15	16	17	18	19	20	21	22	23	24	25	
A																										
B	+	-	+	-	+	-	+	-	+	-	+	-	+	-	+	-	+	-	+	-	+	-	+	-	+	
C		6			5			4			3			2			1									
D	-	-	-	-	-	-	-	-	-	-	-	-	-	-	-	-	-	-	-	-	-	-	-	-	-	
E																										
F	+	-	+	-	+	-	+	-	+	-	+	-	+	-	+	-	+	-	+	-	+	-	+	-	+	
G		7			6			5			4			3			2									
H	-	-	-	-	-	-	-	-	-	-	-	-	-	-	-	-	-	-	-	-	-	-	-	-	-	
I																										
J	+	-	+	-	+	-	+	-	+	-	+	-	+	-	+	-	+	-	+	-	+	-	+	-	+	
K		8			7			6			5			4			3									
L	-	-	-	-	-	-	-	-	-	-	-	-	-	-	-	-	-	-	-	-	-	-	-	-	-	
M																										
N	+	-	+	-	+	-	+	-	+	-	+	-	+	-	+	-	+	-	+	-	+	-	+	-	+	
O		9			8			7			6			5			4									
P	-	-	-	-	-	-	-	-	-	-	-	-	-	-	-	-	-	-	-	-	-	-	-	-	-	
Q																										
R	+	-	+	-	+	-	+	-	+	-	+	-	+	-	+	-	+	-	+	-	+	-	+	-	+	
S		10			9			8			7			6			5									
T	-	-	-	-	-	-	-	-	-	-	-	-	-	-	-	-	-	-	-	-	-	-	-	-	-	
U																										
V	+	-	+	-	+	-	+	-	+	-	+	-	+	-	+	-	+	-	+	-	+	-	+	-	+	
W		11			10			9			8			7			6									
X	-	-	-	-	-	-	-	-	-	-	-	-	-	-	-	-	-	-	-	-	-	-	-	-	-	
Y																										
Z	+	-	+	-	+	-	+	-	+	-	+	-	+	-	+	-	+	-	+	-	+	-	+	-	+	
	1	2	3	4	5	6	7	8	9	10	11	12	13	14	15	16	17	18	19	20	21	22	23	24	25	

State Plane Coordinates (optional)

Zone W WC EC E feet/meters
 NAD 1927 NGVD 1929 NAD 1983 NAVD 1988
 North (Y) = _____ East (X) = _____ EL = _____
 Latitude _____ Longitude _____
 Scale Factor _____ Geoid Height _____

Certification

I, Raymond E. Connin, Wyoming PLS-~~XX~~ 5014 certify that I, or others under my supervision, have performed the work as described above and completed this form.

Company or Agency Hall & Walters, Inc.
 Mailing Address _____
 Street Address 873 North Cleveland
 City, State, ZIP loveland, CO 80537
 Telephone, FAX 303-663-1177



Raymond E. Connin
 Signature, Seal, and Date

8 136

~~Township 16 North Range 6's West~~

~~Claim~~

~~North between sections 24 & 25~~

~~Variation 15.35 E~~

~~by run 30 links wide S E~~

~~Del a granite boulder 16 X 8 X 6~~

~~for quarter section corner~~

~~Del a granite boulder 18 X 10 X 7~~

~~for corner to sections 26, 27, 34 & 35~~

~~Sand rolling Del 2nd rate granite~~

~~grass good~~

~~East On a Random line~~

~~between sections 26 & 35~~

~~Variation 15.35 E~~

~~Del temporary 1/4 section corner~~

~~Intersect N 1/2 S line 19 links~~

~~South of corner to sections 25, 26~~

~~35 & 36 from which corner run~~

~~S 89.34 W On a true line~~

~~between sections 26 & 35~~

~~Del a granite boulder 14 X 10 X 6~~

137 8

~~Township 16 North Range 6's West~~

~~Claim~~

~~for quarter section corner~~

~~corner to sections 26, 27, 34 & 35~~

~~Rolling Del 2nd rate granite~~

~~North between sections 26 & 27~~

~~Variation 15.35 E~~

~~Del a granite boulder 17 X 4 X 5~~

~~for quarter section corner~~

~~Del a granite boulder 18 X 4 X 6~~

~~for corner to sections 22, 23, 24 & 27~~

~~Sand rolling Del 2nd rate granite good~~

~~East On a Random line~~

~~between sections 23 & 26~~

~~Variation 15.35 E~~

~~Del temporary 1/4 section corner~~

~~Intersect N 1/2 S line 66 links~~

~~South of corner to deep 23, 24, 25~~

~~& 26 from which corner run~~

~~S 89.34 W On a true line~~

100

100

100